

# WALL LOUVER MOUNTING OPTIONS

CHANNEL "C" FRAME  
MOUNTING OPTION

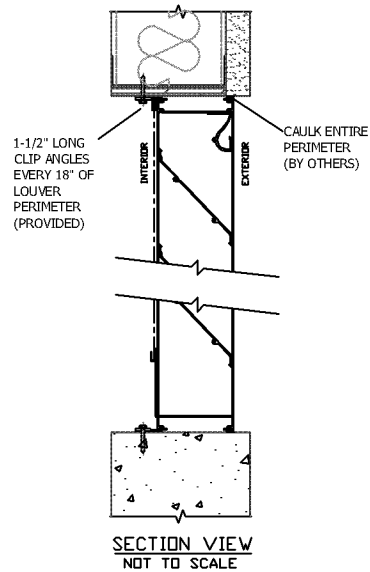

WITH SILL EXTENSION  
MOUNTING OPTION

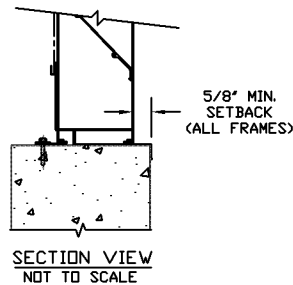

FLANGE "F" FRAME  
MOUNTING OPTION

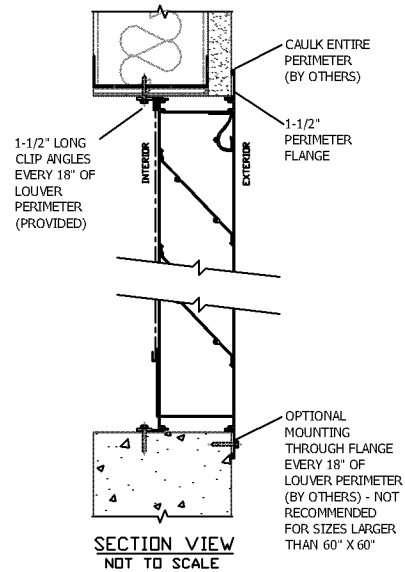

FOR ALL WALL TYPES

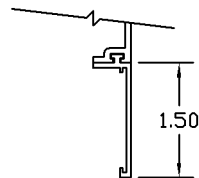

FLANGE "F" FRAME  
DETAIL

"J" CHANNEL FRAME  
MOUNTING OPTION

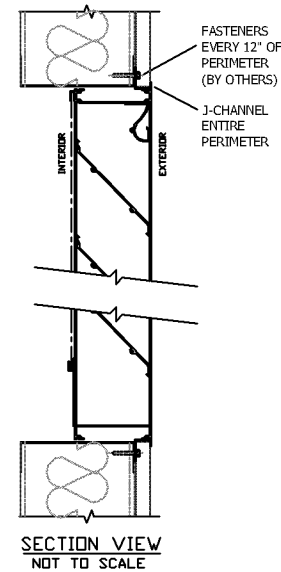

FOR SIDING OR STUCCO  
EXTERIOR SURFACE

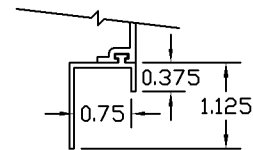

"J" CHANNEL  
FRAME DETAIL

GLAZING "G" CHANNEL  
FRAME MOUNTING  
OPTION

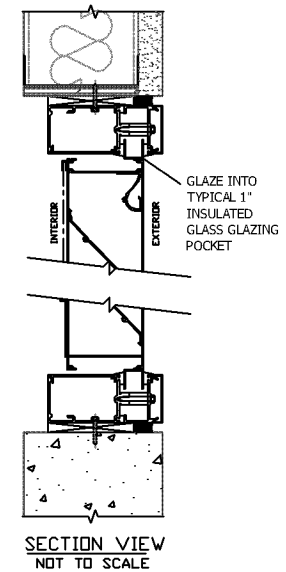

FOR GLASS AND  
CURTAIN WALL SYSTEMS

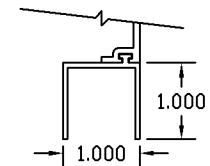

GLAZING "G" CHANNEL  
FRAME DETAIL

**ARCHITECTURAL  
L·O·U·V·E·R·S**

266 West Mitchell Ave - Cincinnati, OH 45232  
PH: (888) 568-8371 Fax: (888) 568-8370

NOTE: LOUVER WITH 4" FRAME  
DEPTH AND WALL WITH 6" DEPTH  
SHOWN. ALL FRAME OPTIONS ARE  
AVAILABLE FOR ALL LOUVER  
MODELS

PROJECT			
CONTRACTOR			
ARCHITECT			
DRAWN BY: JRR	DATE: 08/2007	DRAWING TYPE: TECHNICAL SHEET	DRAWING TITLE: MOUNTING OPTIONS